

Commercial in Puerto Banús

Reference: R4333858



Bedrooms: 2
Status: Sale

Bathrooms: by request
Property Type: Commercial

M²: 227
Parking places: by request

Price: 1,029,000 €
Printing day : 2nd July 2026

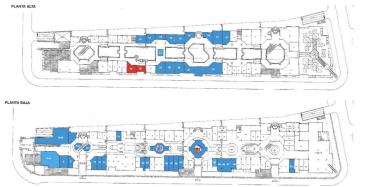

Overview: These are two units linked together. Cristamar is a mall comprised by 114 local commercial in the heart of Puerto Banus, three levels with underground parking for your clients on the ground floor restaurants, shops, and services, pharmacy at the north corner a gym, and on the second floor offices

Features:

None, Close to beach, Air conditioning, Lift, Investment, Resale